

**GENUINE
REPLACEMENT WICK**



KEROSENE HEATERS

NAME	COTTON WICK
PART NO.	22742213
MODEL	Rainbow A(RB-2), TSC-15 Moonlighter pre-H, Omni 15
Q'TY.	1 pc.

TOYOTOMI U.S.A., INC.
P.O. BOX 176
Brookfield, CT. 06804-0176

MADE AND PRINTED IN JAPAN

Remove the wick holder and take out the wick.

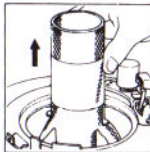

Fold the replacement wick and insert it into the wick holder. Position the wick so that the red guide line of the wick is even with the top of the wick holder. Then open the wick and press it uniformly against the inner wall of the holder.

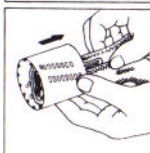

Insert the wick holder into the wick adjuster so that the gear mechanism is engaged.



Place the wick guide in the center air tube before installing wick. **IMPORTANT**— Remove wick guide before installing wick adjuster. If guide is not removed, it will restrict air flow and cause improper combustion and may smoke.

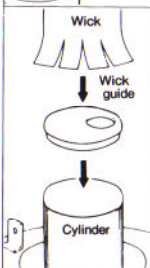

REPLACING THE WICK

WARNING: Before disassembling your heater, allow it to cool completely. Remove the batteries from the battery holder.

After the heater has cooled, remove the three thumb screws from the mantle cover and lift it with the handle.

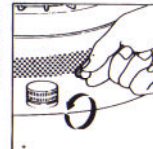

With the wick at its lowest position, remove the flame spreader by turning it slightly to the right. Remove the extinguisher ring.

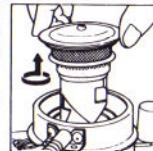

Disconnect the electrical leads at the battery holder. Press down the extinguisher lever and remove the burner cover.

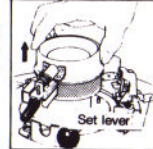

Unfasten the three wing nuts from the tank and then rotate the retainers to allow removal of the wick adjuster assembly. Lift out the wick adjuster assembly.

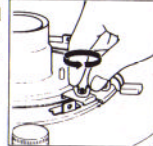

Align the wick adjuster spindle with the arrow as shown in the photograph and carefully slide the wick adjuster unit into position. Make sure that all the wick segments go fully into the tank and remove the wick guide. Fasten the wick adjuster unit with the retainers and wing-nuts. Turn the wick adjuster knob in both directions to check that the wick moves smoothly.

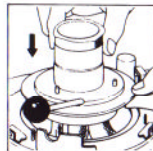

Reinstall the burner cover and connect the electrical leads (RED wire is +).



Replace the extinguisher ring with its brim positioned down. Install the flame spreader and refasten the mantle cover securely with the screws.

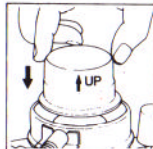

CORRECT HEIGHT OF WICK

